

Power Rocker Switches / ILLUMINATED



M1 Series



Panel Thickness	Dim. X	Dim. Y
0.75 - 1.25	28.5 - 28.6	13.5 - 13.6
1.25 - 2.00	28.6 - 28.7	13.5 - 13.6
2.00 - 3.00	28.8 - 28.9	13.5 - 13.6

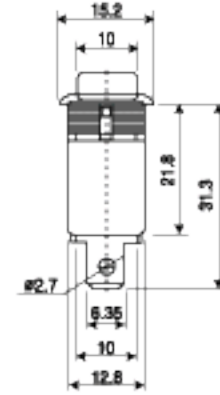
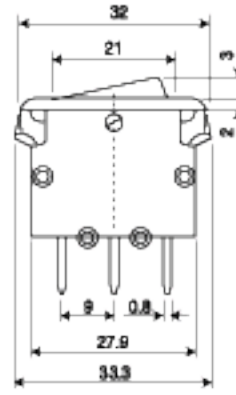
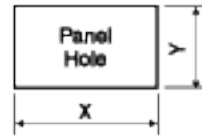

Two in One W/ Circuit Breaker

81 Series



MODEL NO.	TYPE
811	ON OFF
81L	ON OFF Illuminated
816	ON ON

Solid Rocker W/ Two Colors Optional:
 Gray / Red
 Black / Red
 White / Red

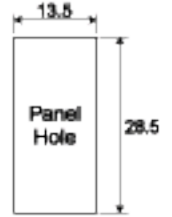
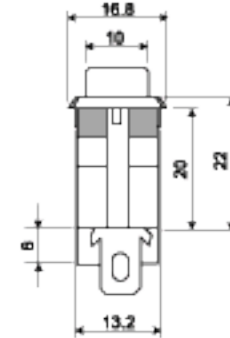
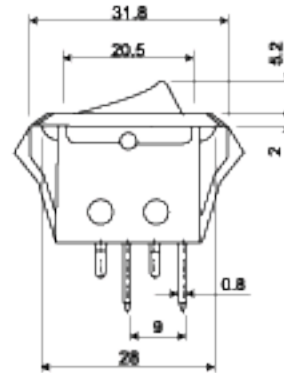

15A 125V AC
 10A 250V AC

82 Series



MODEL NO.	TYPE
82	SPST ON OFF
82L	SPST Illuminated

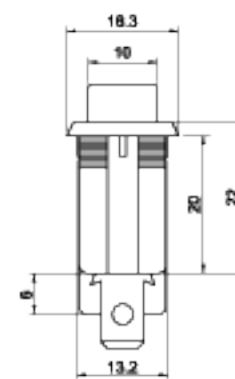
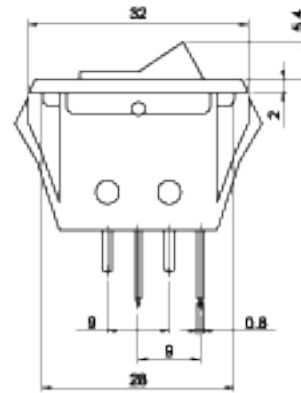
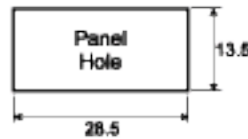

81 SEAL CAP

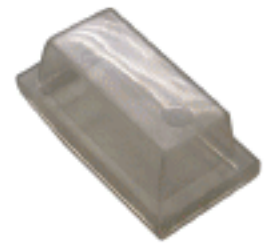

15A 125V AC
 10A 250V AC

606P Series



MODEL NO.	TYPE
RS-606PA	DPST ON OFF
RS-606PB	DPDT ON ON
RS-606PC	DPDT ON OFF ON
RS-606PD	DPST (ON) OFF
RS-606PE	DPST ON (OFF)
RS-606PF	DPDT (ON) ON
R13-33B	DPST Illuminated
R13-33D	DPDT ON OFF ON
R13-33H	DPDT ON OFF (ON)
R13-33I	DPDT (ON) OFF (ON)

RS-606P: 6A 250V AC
 * SS24: 16A 250V AC

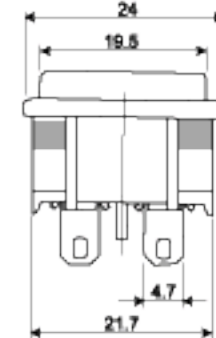
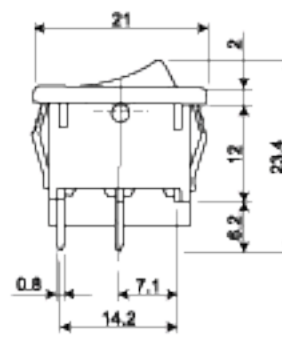

606P SEAL CAP



PANEL HOLE: 22x19.4mm

R5 series



MODEL NO.	TYPE
R515	DPST ON OFF
R525	DPDT ON ON
R535	DPDT ON OFF ON
R545	DPDT ON (ON)
R555	DPST OFF (ON)
R565	DPDT (ON) OFF (ON)
R575	DPDT ON (OFF)
R585	DPDT ON OFF (ON)
R595	DPST Illuminated

16A 250V AC
 20A 125V AC

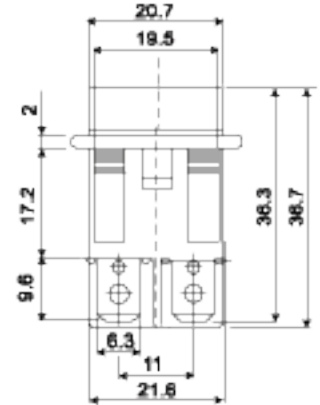
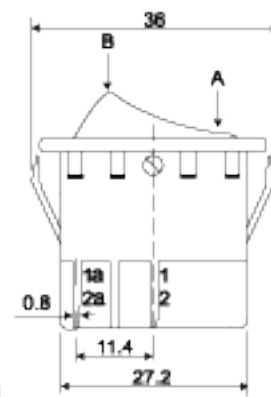
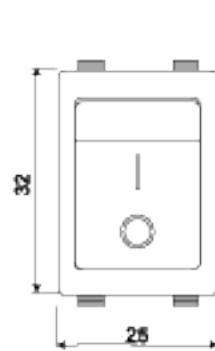

Panel Hole: 22X30mm

HOW TO ORDER

MODEL NO.	+	HOUSING COLOR	+	ROCKER COLOR	or	LAMP COLOR	+	MARKING	+	TERMINAL TYPE	+	LAMP VOLTAGE	+	LAMP COLOR
		B : BLACK W : WHITE G : GRAY		B : BLACK W : WHITE G : GRAY R : RED Y : YELLOW GN : GREEN		R : RED Y : YELLOW GN : GREEN		O A B C D E F G H		T S		□ : NO LAMP 1 : 125V AC 2 : 250V AC 3 : 12V DC 4 : 24V DC		* For R495 □□□□ T□□ Dot Illuminated only R : RED Y : YELLOW GN : GREEN